

SITE PLAN OF A PIECE AND PARCEL OF LAND AT PREMISES NO -194/1, BANGUR AVENUE, BLOCK-B, KOLKATA- 55; HOLDING NO.-1500,, BANGUR AVENUE; C.S. DAG NO. - 1305/1328; C.S. KHATIAN NO.834; MOUZA-SHYAM NAGAR; J.L. NO.- 32 / 20; P.S.- LAKE TOWN; UNDER S.D.D.M. ; WARD NO.- 29; DIST.- 24 PGS (N).

AREA STATEMENT:-

AREA OF LAND (AS PER DEED): 3K-06CH-29 SFT(228.45 SQM)
 AREA OF LAND (AS PER MEASUREMENT): 230.842 SQM
 EXCESS AREA OF LAND (GIFTED): 2.392 SQM
 AREA OF LAND (AFTER GIFTING): 3K-06CH-29 SFT(228.45 SQM)
 PERMISSIBLE COVERED AREA: (63.57%)=145.22 SQM

CERTIFICATE OF OWNER

I/WE ALSO UNDERTAKE TO REPORT THAT THERE IS NO COURT CASE OR ANY COMPLAIN FROM ANY CORNER IN RESPECT OF MY/OUR PROPERTY AS PER PLAN.
 I/WE HERE BY DECLARE THAT I/WE WILL REPAIR/RECONSTRUCT IF ANY DAMAGE CAUSED TO THE EXISTING DRAIN WHILE CONSTRUCTION.FURTHER THERE IS NO TENANT IN THE AFORESAID PREMISES.S.D.D.M. WILL NOT BE LIABLE FOR ANY TYPE OF DISPUTE IF ARISES IN FUTURE.

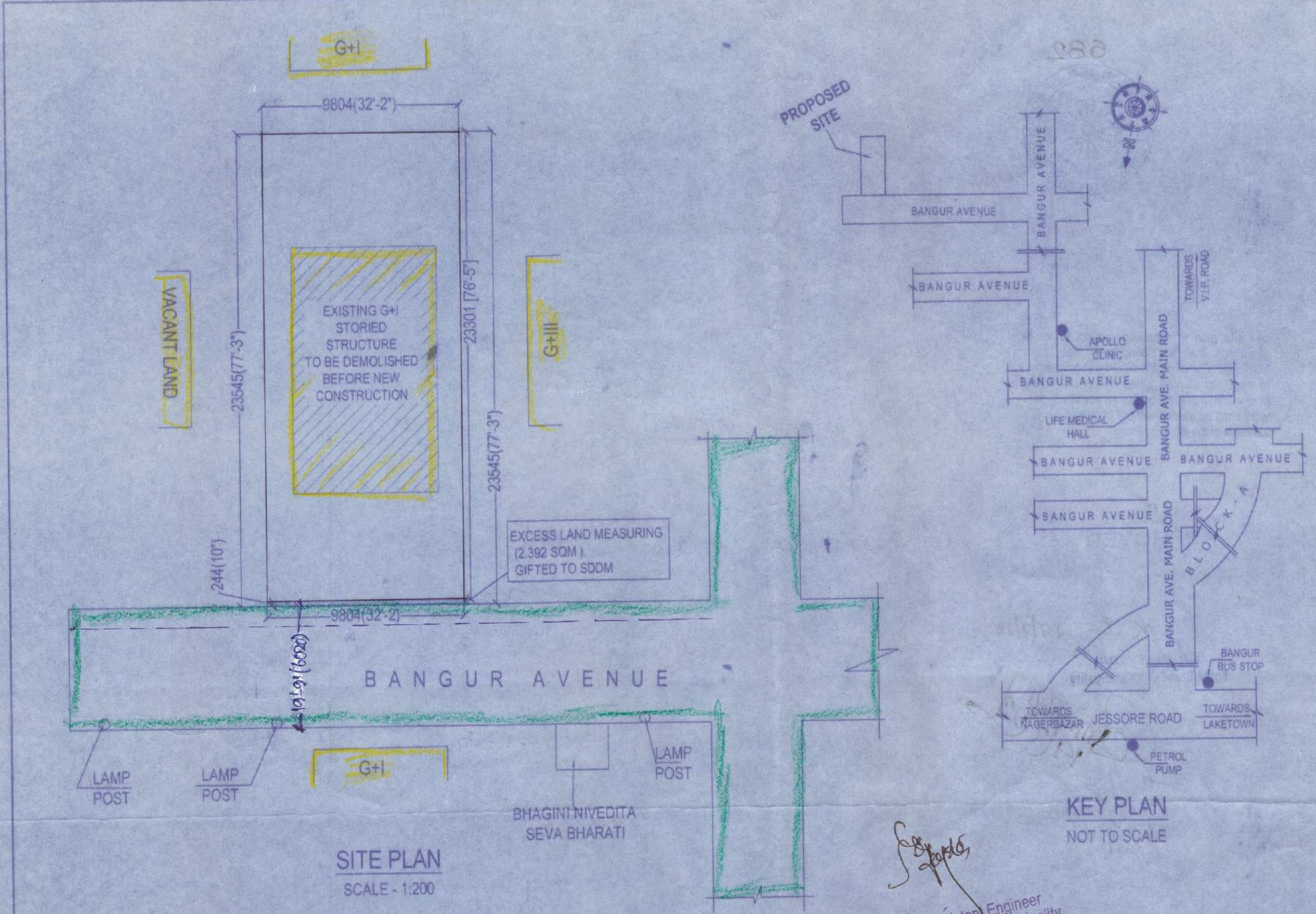

SITE PLAN
SCALE - 1:200

KEY PLAN
NOT TO SCALE

[Signature]
Sub-Assistant Engineer
South Dum Dum Municipality

[Signature]
Sanjula Holani

Signature Of Owner/s

- NOTE:**
1. ALL DIMENSIONS ARE IN M.M.
 2. SCALE AS SHOWN.
 3. SITE PLAN FOR A PROPOSED RESIDENTIAL BUILDING AS PER S.D.D.M BUILDING RULE.

[Signature]
Dhiman Bhattacharjee
Licence Building Surveyor
Class-I
L.B.S No.: SDDM/02/
SIGNATURE OF PLANMAKER



PREPARED BY:

D.J. CONSULTANTS & ASSOCIATES
255, DUMDUM PARK, KOL - 55.
PHONE NO - 033-3554 8615
mail. - info@djcon.org

682



The site plan is approved subject to the conditions that the conditions that the Municipality shall not be held responsible in case any dispute arises out of the title or ownership of the site and no construction work shall be started without obtaining prior sanction of the Building Plan.

APPROVED

K.C. 19/7/23.

Chairperson
South Dum Dum Municipality

A handwritten signature in black ink, appearing to be "K.C.", with the date "19/7/23" written below it.

Sub-Assistant Engineer
South Dum Dum Municipality

L.B.S. No. SDDM/031
Class-I
Licence Building Surveyor
Dum Dum Municipality